

FRONT VIEW

SECTION 'A-A'

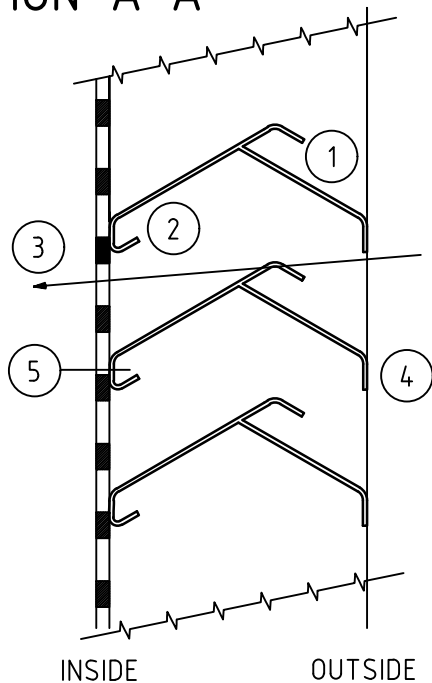

LOUVRES:— APPROX. 90W x 60 PITCH.

1. TRAP No.1
2. TRAP No.2
3. OBSCURED SIGHT LINE
4. STIFFENED OUTSIDE EDGE
5. FLAT BLADE EDGE FOR FIXING MESH

NOTES

1. INLET VENTILATOR TO BE A MAXIMUM 300mm ABOVE FLOOR LEVEL.
2. OUTLET VENTILATOR TO BE A MAXIMUM 300mm BELOW THE CEILING.
3. MINIMUM AREA PER VENTILATOR IS TO BE ONE SQUARE METRE.
4. FASTEN FRAMING TO THE BUILDING STRUCTURE WITH DURABLE CORROSIVE RESISTANT FASTENERS TO PROVIDE A SECURE PERIMETER. ALL FASTENERS VISIBLE FROM THE OUTSIDE ARE TO HAVE BLIND HEADS OR ARE TO BE VANDAL RESISTANT FASTENERS.
5. WEATHER PROOF SAFETY LOUVRES TO RESTRICT OBJECTS BEING PUSHED BETWEEN THE BLADES. McKECHNIE N0.9517 OR APPROVED EQUAL. VERMIN PROOFING ALUMINIUM 'OMAMESH' CA1615 OR 'EXPAMET' 09.16AL.
6. TYPICAL VENTILATOR SHOWN. SHOP DRAWINGS FOR ALTERNATIVES ARE TO BE PRESENTED TO EVOENERGY FOR REVIEW AND APPROVAL.

				The information contained within this drawing & associated electronic file shall remain the property of Evoenergy and shall not be copied or used for any other purpose without express written permission from Evoenergy. © Evoenergy. 2018.	
D	LOGO AND REFERENCES UPDATED	18/03/2018	B. Suthar	W. Ibrahim	ACT Cadastral information supplied by the ACT Environment & Sustainable Development Directorate. © ACT Gov. 2018.
C	LOGO UPDATED	28/03/2008	AC	GA	
No	Revision	Date	Checked	Approved	
evoenergy				Drawn:	S.Read
INLET & OUTLET VENTILATORS FOR INDOOR CHAMBER SUBSTATIONS				Date:	22/02/1996
				Designed:	E. Amaratunga
				Checked:	M. Charlton
				Approved:	
Project No:	Status: Current	A4		4951-07	
Work Pack No:	File:				