

NOTES:

1. FOR SITE EXCAVATION AND PLINTH DETAILS, REFER TO DRAWING D303-0010.
2. ALL LABELLING MUST BE VERIFIED ON-SITE.
3. ALL CABLE TERMINATIONS MUST BE MADE AT THE FUSEWAY OR BUSHING NOMINATED IN THE SITE SPECIFIC DESIGN.
4. ANY VARIATION TO THE SITE SPECIFIC DESIGN MUST BE CONSULTED WITH AND APPROVED BY THE PROJECT ENGINEER PRIOR TO ENERGISATION.
5. ALL DIMENSIONS IN MILLIMETRES UNLESS OTHERWISE SHOWN.
6. PADMOUNT SUBSTATION EARTHING TYPE SHALL BE SELECTED BY ASSESSMENT AT THE DESIGN STAGE IN ACCORDANCE WITH "PO07127- DISTRIBUTION EARTHING DESIGN MANUAL".
7. CABLES AND EARTHING CONDUCTORS MUST BE BACKFILLED WITH BEDDING SAND COMPLIANT WITH "PO07330 - QUARRY PRODUCT AND RAW MATERIALS - TECHNICAL SPECIFICATION".
8. BACKFILL MUST CONTAIN NO ROCKS, RUBBISH, VEGETATION, TIMBER, CONTAMINANTS OR SHARP MATERIAL.
9. CABLES MUST BE COVERED WITH POLYMERIC WARNING TAPE IN THE EXCAVATED AREA BETWEEN THE TERMINATION OF THE UNDERGROUND CONDUIT AND THE POINT WHERE THE CABLES RISE VERTICALLY TO THE TERMINATION, 150mm ABOVE THE UNDERSIDE OF EACH CABLE.
10. BACKFILL MUST BE COMPACTED AS PER "PO0793 - CIVIL WORKS MANUAL VOLUME 2".
11. SEPARATE EARTHING SYSTEM FOR ILLUSTRATION PURPOSES ONLY. EARTHING SYSTEM TO BE DETERMINED BY ASSESSMENT IN CONSULTATION WITH "PO07127 - DISTRIBUTION EARTHING DESIGN MANUAL".
12. CABLES MUST BE SECURELY CLAMPED TO THE HV SWITCHGEAR USING THE INTGRAL CABLE CLAMPS AND TO THE LV SWITCHBOARD WITH APPROPRIATELY SIZED POLYMER CLEATS PRIOR TO TERMINATION. ENSURE CABLE WEIGHT IS NOT SUPPORTED BY SWITCHGEAR BUSHINGS OR FUSEWAYS.

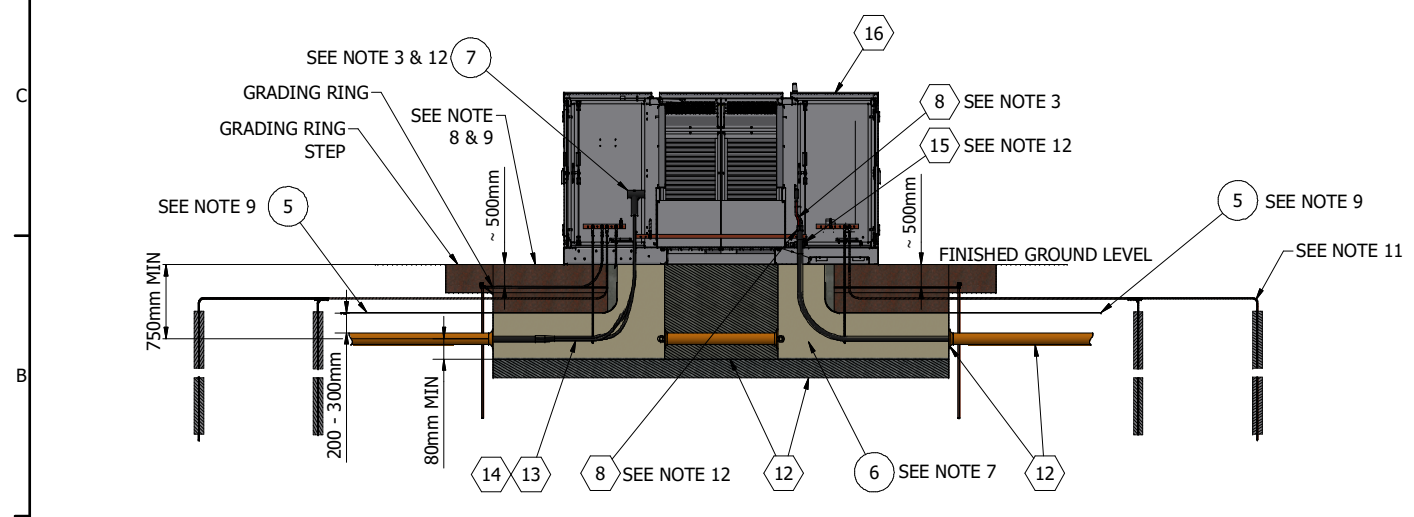
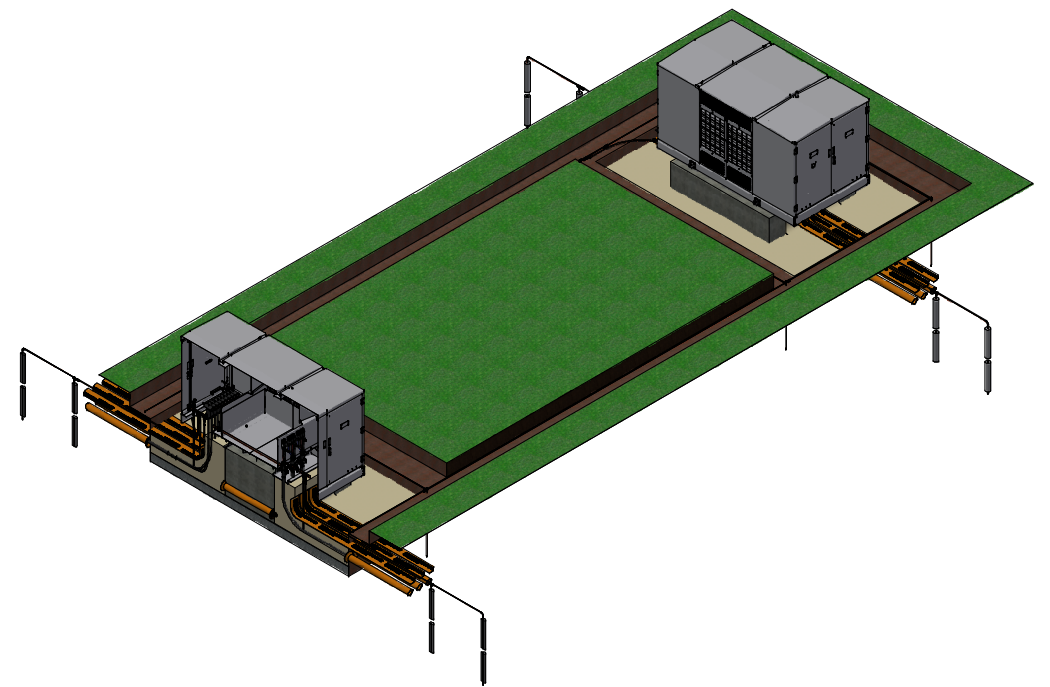

ITEM	UA TYPE	DESCRIPTION	STOCK CODE	QTY	DRAWING NO
1	P	ASSET NUMBER PLATE, SUBSTATION, SWITCHING STATIONS, GAS SWITCH RECLOSER	-	2	D107-0011
2	P	CABLE, 240mm ² , 4C, SECTOR, STRANDED AL, 0.6/1kV, XLPE, 90° STRANDED H68 AL, XLPE INSULATED, TAPED PVC SHEATHED	1156172	AR	D102-0007
3	P	LABEL, CABLE DESTINATION, 40 x 75mm	-	AR	D107-0013
4	P	LABEL, CABLE DESTINATION, 40 x 140mm	-	AR	D107-0014
5	P	CABLE PROTECTION COVER, UNDERGROUND, POLYMERIC, DOUBLE SIDED. 200mm WIDE, MANUFACTURED IN ACCORDANCE WITH AS/NZS 4702-2000	1153882	AR	D103-0140
6	P	BEDDING SAND AS PER EVOENERGY QUARRY PRODUCTS AND RAW MATERIALS TECHNICAL SPECIFICATION	-	AR	D109-0004
7	P	CONNECTOR, SEPARABLE BOLTED TEE, 11kV 630A, TYPE C INTERFACE, FOR 240mm ² XLPE CABLE, M16 SHEAR BOLT LUG, 3ph KIT	1208972	AR	D103-0174
8	S	SA, TERMINATIONS, 240mm ² AL 4 CORE INDOOR TERMINATION	-	AR	D302-0014
9	S	SA, EARTHING, SEPARATE EARTHING HV AND LV TWIN PADMOUNT SUBSTATION 3m - 10m SEPARATION	-	AR	D303-0020
10	S	SA, EARTHING, CMEN EARTHING WITH ELECTRODES HV & LV TWIN PADMOUNT SUBSTATION 3m - 10m SEPARATION	-	AR	D303-0021
11	S	SA, EARTHING, CMEN EARTHING WITH GRID PADMOUNT SUBSTATION 3m - 10m SEPARATION	-	AR	D303-0022
12	S	SA, FOUNDATIONS, 500kVA - 1500kVA TWIN PADMOUNT 3m - 10m SEPARATION SUBSTATION FOUNDATION	-	1	D303-0019
13	I	INTERFACE, HV CABLE TERMINATION TO SUIT	SELECT	AR	D199-0011
14	I	INTERFACE, HV CABLE TO SUIT	SELECT	AR	D199-0008
15	I	INTERFACE, CLEAT TO SUIT	SELECT	AR	D199-0002
16	I	INTERFACE, PADMOUNT SUBSTATION TO SUIT	SELECT	2	D199-0005

No.	DESCRIPTION	OKD	AUTH	DATE
A	EARTHING CONNECTIONS UPDATED	JJP	WNI	30/01/2020
B	NOTES AND TITLE AMENDED - KV	NAA	WJC	12/08/2022
C	ADDED CLEATS TO BOM	JJP	NAA	30/05/2024



Drawn:	3rd Dim
Designed:	J. Primmer
Checked:	J. Primmer 28/01/2020
Branch Engineer:	W. Ibrahim
Branch Manager:	W. Cleland
Old Drawing No. and Revision:	Rev

STANDARD CONSTRUCTION, DISTRIBUTION
 UNDERGROUND, STATIONS,
 CA, PADMOUNTS,
 500kVA - 1500kVA TWIN PADMOUNT SUBSTATION
 3m - 10m SEPARATION

Scale:	Date:	Sheet No.:
Project No.:	Stock Code:	
Status:	Current	
A1	D303-0026	Rev